

## End mill – Style D Ball End (Full Radius)

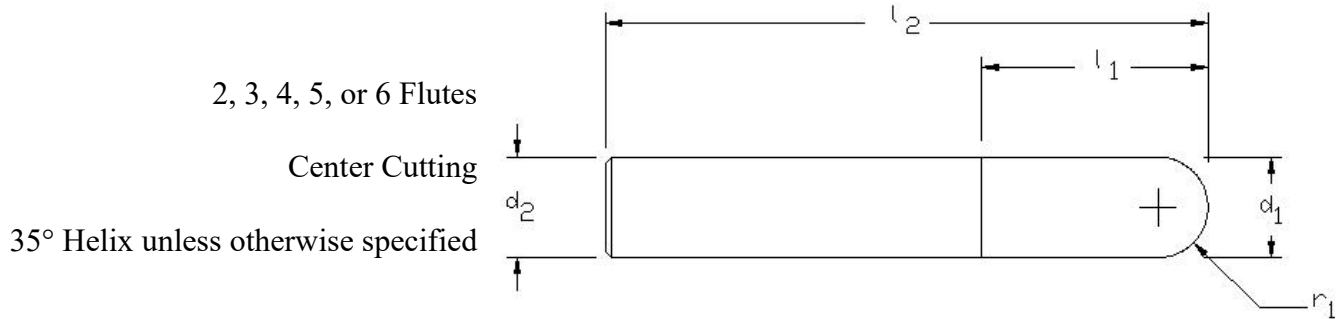

Tolerances unless otherwise specified below:

$$d_1^{+0.000''/-0.002''} \quad d_2^{+0.0000''/-0.0005''} \quad l_1^{+0.040''/-0.000''} \quad l_2 \pm 0.060'' \quad r_1 \pm 0.002''$$

d <sub>1</sub> End Mill Diameter:		d <sub>2</sub> Shank Diameter:	
Other Tolerance:		Other Tolerance:	
l <sub>1</sub> Cutting Length:		l <sub>2</sub> Overall Length:	
Other Tolerance:		Other Tolerance:	
r <sub>1</sub> Corner Radius: (Ball End) r <sub>1</sub> = 0.5 x d <sub>1</sub>			
Other Tolerance:			
Number of Flutes:		Material: HSS	Carbide
		Cobalt	
Quantity:	Coated: Yes No	Weldon Flat: Yes No	
Material to be cut:		Due Date:	
Company Name:		Contact Name:	
Address:			
Address Cont.:			
Email:		Phone:	
Comments:			

